

- ROAD NOTES:**
1. ALL ROADWORKS TO BE UNDERTAKEN IN ACCORDANCE WITH THE TRANSPORTATION INFRASTRUCTURE IRELAND (TII) PUBLICATIONS AND SPECIFICATIONS FOR ROADWORKS.
 2. ALL ROADWORKS TO BE UNDERTAKEN IN ACCORDANCE WITH THE 'RECOMMENDATIONS FOR SITE DEVELOPMENT WORKS FOR HOUSING AREAS' AND THE BITUMINOUS LAYERS SHALL BE IN ACCORDANCE WITH TII PUBLICATIONS NRA SPECIFICATION FOR ROAD WORKS SERIES 900 ROAD PAVEMENT-BITUMINOUS MATERIALS'.
 3. ALL FOOTPATHS TO BE UNDERTAKEN IN ACCORDANCE WITH 'TII SPECIFICATION FOR ROAD WORKS SERIES 1100 - KERBS, FOOTWAYS AND PAVED AREAS. THE DISHING OF FOOTPATHS SHALL BE CONSTRUCTED IN ACCORDANCE WITH THE 'GUIDANCE ON THE USE OF TACTILE PAVING SURFACES DOCUMENT'.
 4. ALL ROAD MARKINGS SHALL BE IN ACCORDANCE WITH 'IS EN 1436 EUROPEAN STANDARD FOR ROAD MARKINGS' & IN ACCORDANCE WITH THE 'TRAFFIC SIGNS MANUAL'.
 5. ALL ROAD MARKINGS SHALL BE IN ACCORDANCE WITH 'IS EN 1436 EUROPEAN STANDARD FOR ROAD MARKINGS' & IN ACCORDANCE WITH THE 'TRAFFIC SIGNS MANUAL'.
 6. ALL ROAD SIGNS SHALL BE IN ACCORDANCE WITH 'IS EN 1436 EUROPEAN STANDARD FOR ROAD MARKINGS' & IN ACCORDANCE WITH THE 'TRAFFIC SIGNS MANUAL'.

- LEGEND:**
- PROPOSED SITE RED-LINE BOUNDARY
 - PROPOSED DWELLING / BUILDING FOOTPRINT
 - PROPOSED ASPHALT ROADS (BLACK)
 - PROPOSED RAISED TABLES, ROUND-TOP RAMP AND JUNCTIONS (BLACK)
 - PROPOSED CONCRETE FOOTPATHS
 - PROPOSED ASPHALT SHARED PEDESTRIAN / CYCLE WAY - ACTIVE TRAVEL NETWORK (BLACK)
 - PROPOSED SHARED SURFACE ROADS (BUFF)
 - PROPOSED PERMEABLE PAVER PARKING (WITHIN CURTLIDGE OF DWELLINGS)
 - PROPOSED PERMEABLE PAVER PARKING (VISITORS AND NOT WITHIN CURTLIDGE OF DWELLINGS)
 - PROPOSED LANDSCAPE FOOTPATHS
 - PROPOSED 'BLISTER TYPE' TACTILE PAVERS, UNCONTROLLED CROSSINGS, BUFF COLOURED.
 - PROPOSED 'LADDER TYPE' TACTILE PAVERS, BUFF COLOURED.
 - PROPOSED ROAD LEVELS
 - PROPOSED FINISHED FLOOR LEVELS

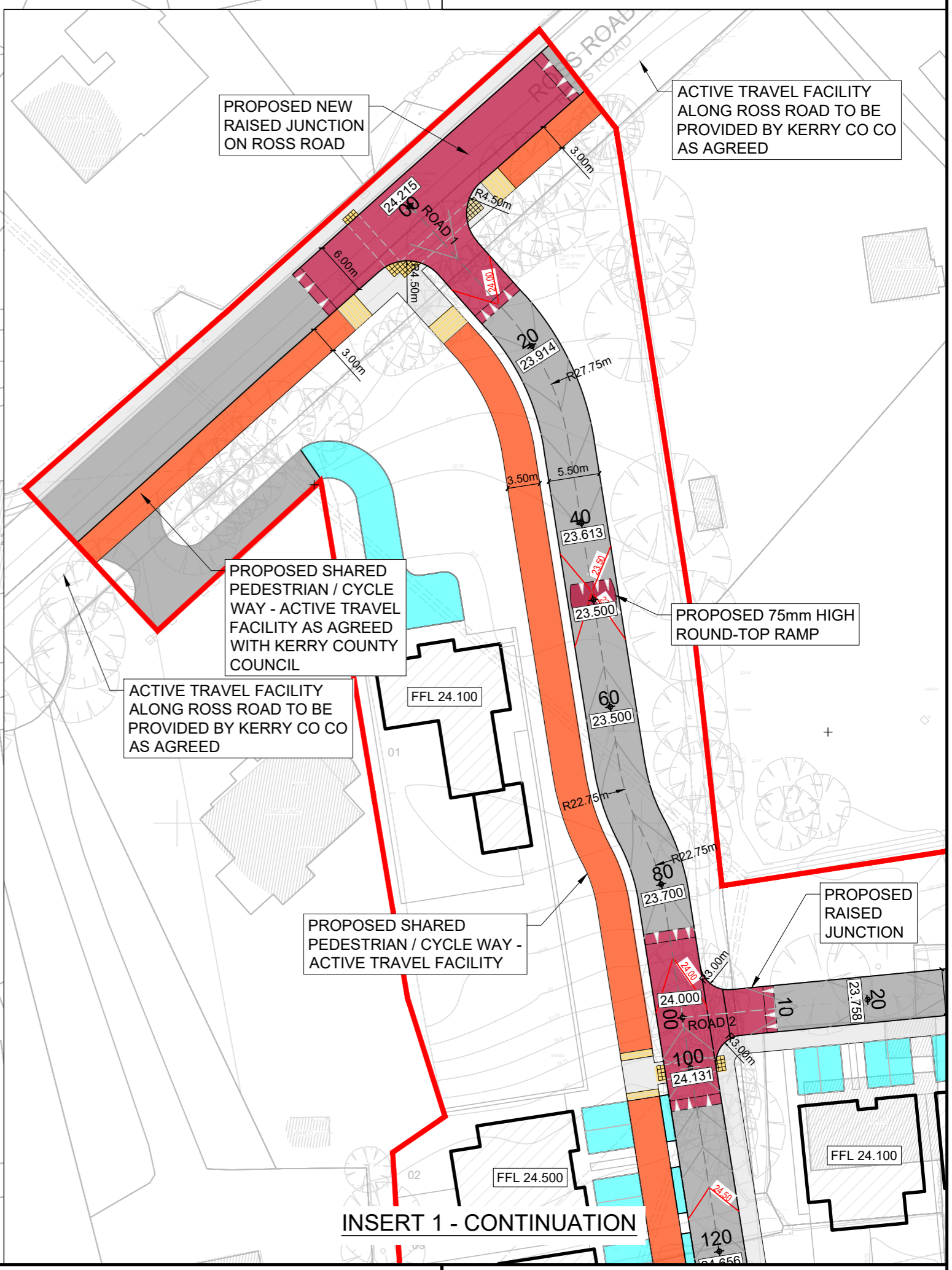

- GENERAL NOTES:**
1. ALL DIMENSIONS ARE IN METERS UNLESS NOTED OTHERWISE.
 2. ALL LEVELS ARE TO MALIN HEAD DATUM.
 3. ONLY WRITTEN DIMENSIONS SHALL BE USED. NO DIMENSIONS SHALL BE SCALED FROM THE DRAWINGS. CONTRACTOR TO CHECK ALL DIMENSIONS ON SITE.
 4. ALL COORDINATES ARE TO IRISH TRANSVERSE MERCATOR.
 5. ALL DRAWINGS ARE TO BE READ IN CONJUNCTION WITH THE PROJECT SPECIFICATIONS.
 6. ALL DRAWINGS ARE TO BE READ IN CONJUNCTION WITH THE PROJECT SPECIFICATIONS.
 7. COPYRIGHT OSL.

REV	DATE	DESCRIPTION	BY	CHKD	AUTH
P05	01.08.25	ISSUED FOR PLANNING	BJM	DB	DB
P04	21.07.25	ISSUED FOR INFORMATION	BJM	DB	DB
P03	12.06.25	ISSUED FOR INFORMATION	BJM	DB	DB
P02	09.04.25	ISSUED FOR SECTION 32B SUBMISSION	DV	BJM	DB
P01	28.03.25	ISSUED FOR INFORMATION	DV	BJM	DB

OSL-BUTLER
CONSULTING ENGINEERS

Civil, Structural & Project Engineering Services
Unit 38 Eastgate Drive, Little Island, Cork T45 Y049
Tel: +353 21 4297672

CLIENT: HOMELAND PROJECTS LTD.

PROJECT: LARGE-SCALE RESIDENTIAL DEVELOPMENT AT ROSS ROAD, KILLARNEY, CO. KERRY

PURPOSE: FOR PLANNING

TITLE: PROPOSED ROAD LAYOUT PLAN

ORIGINAL SCALE: A1 - 1:500

ORIGINAL ISSUE DATE: 27.02.25

STATUS: S2

DRAWING NO: 24041-OSL-11-DR-C-1110

REV: P05