

- SURFACE WATER NOTES:**
- ALL WORK TO BE IN ACCORDANCE WITH THE GREATER DUBLIN REGIONAL CODE OF PRACTICE FOR DRAINAGE WORKS VERSION 6.0
- LEGEND:**
- PROPOSED SITE RED-LINE BOUNDARY
 - PROPOSED DWELLING / BUILDING FOOTPRINT
 - PROPOSED FINISHED FLOOR LEVELS
 - PROPOSED ROAD CONTOURS
MAJOR CONTOURS RED
MINOR CONTOURS GRAY
 - PROPOSED SURFACE WATER PIPE (SIZE, SLOPE AND FLOW DIRECTION AS SHOWN ON LAYOUT)
 - PROPOSED BACKDROP ENTRY INVERT LEVEL TO SURFACE WATER MANHOLE
 - EXISTING SURFACE WATER PIPE
 - PROPOSED SURFACE WATER MANHOLE WITH MANHOLE INFORMATION SHOWN
 - EXISTING SURFACE WATER MANHOLE WITH MANHOLE INFORMATION SHOWN
 - PROPOSED SURFACE WATER INSPECTION CHAMBER
 - PROPOSED SURFACE WATER 100mm Ø SERVICE CONNECTION
 - PROPOSED ROAD GULLY WITH 150mm Ø CONNECTION
 - PROPOSED KERB INLET
 - PROPOSED SWALE
 - PROPOSED PERMEABLE PAVING, PUBLIC PARKING
 - PROPOSED PERMEABLE PAVING, PRIVATE PARKING
 - TREE PIT + KERB GULLY
 - PROPOSED DETENTION POND
 - PROPOSED ATTENUATION TANK

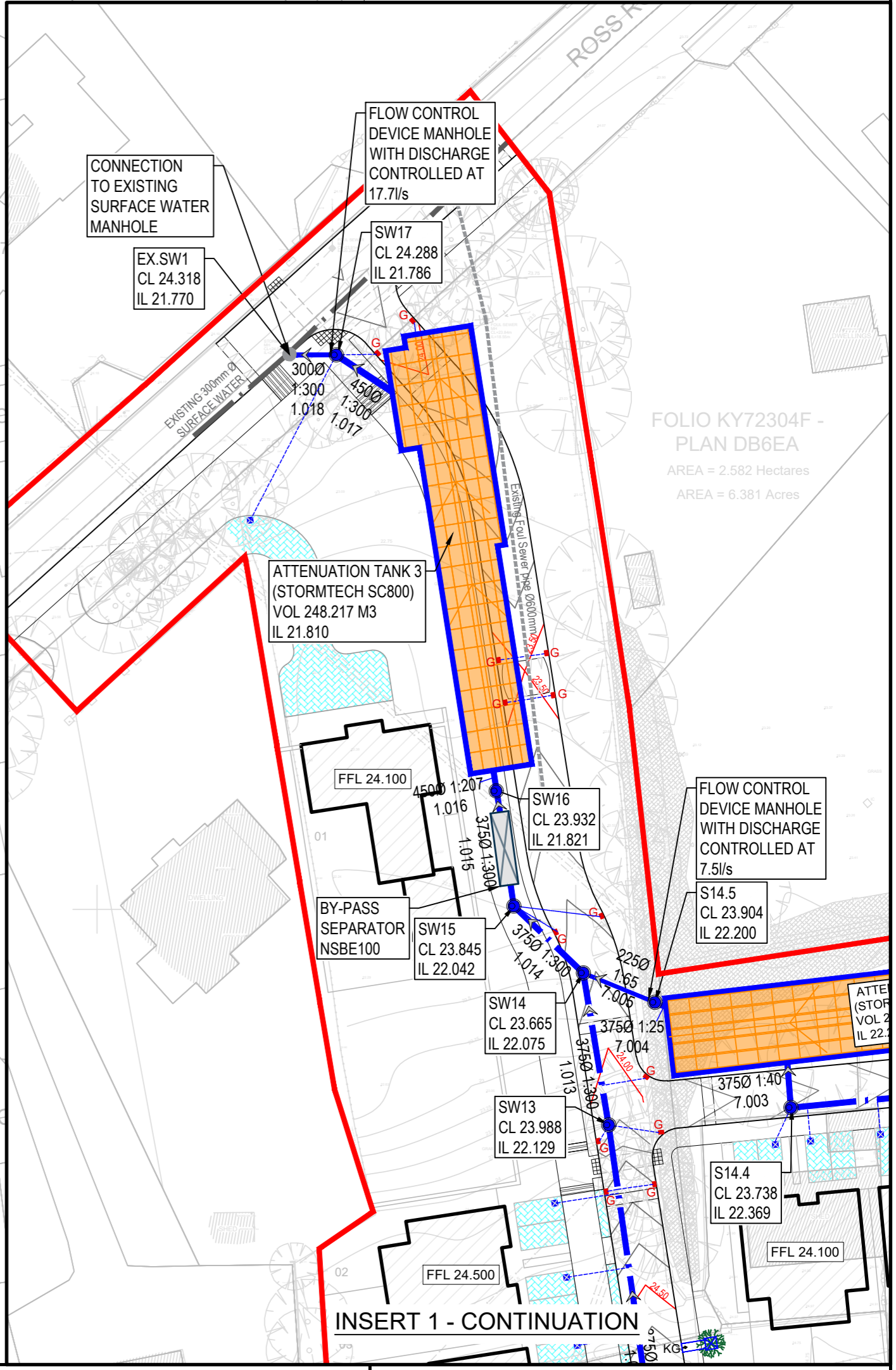

- GENERAL NOTES:**
- ALL DIMENSIONS ARE IN METERS UNLESS NOTED OTHERWISE.
 - ALL LEVELS ARE TO MALIN HEAD DATUM.
 - ONLY WRITTEN DIMENSIONS SHALL BE USED. NO DIMENSIONS SHALL BE SCALED FROM THE DRAWINGS. CONTRACTOR TO CHECK ALL DIMENSIONS ON SITE.
 - ALL COORDINATES ARE TO IRISH TRANSVERSE MERCATOR.
 - ALL DRAWINGS ARE TO BE READ IN CONJUNCTION WITH THE PROJECT SPECIFICATIONS.
 - COPYRIGHT OSL.

REV	DATE	DESCRIPTION	BY	CHKD	AUTH
P03	01.08.25	ISSUED FOR PLANNING	BJM	DB	DB
P02	09.04.25	ISSUED FOR SECTION 32B SUBMISSION	DB	BJM	DB
P01	28.03.25	ISSUED FOR INFORMATION	DV	BJM	DB

OSL-BUTLER
CONSULTING ENGINEERS

Civil, Structural & Project Engineering Services
Unit 38 Eastgate Drive, Little Island, Cork T45 Y049
Tel: +353 21 4297672

CLIENT: HOMELAND PROJECTS LTD.

PROJECT: LARGE-SCALE RESIDENTIAL DEVELOPMENT AT ROSS ROAD, KILLARNEY, CO. KERRY

PURPOSE: FOR PLANNING

TITLE: PROPOSED SURFACE WATER LAYOUT

ORIGINAL SCALE: A1 - 1:500

ORIGINAL ISSUE DATE: 27.02.25

STATUS: S2

DRAWING NO: 24041-OSL-11-DR-C-1120

REV: P03