

- WATER NOTES:**
1. ALL WORK TO BE IN ACCORDANCE WITH THE UE CODE OF PRACTICE FOR WATER INFRASTRUCTURE AND WATER INFRASTRUCTURE STANDARD DETAILS WATERMAIN MATERIAL SHALL BE HDPE PE-100 SDR17 IN ACCORDANCE WITH SECTION 3.9 OF UE CODE OF PRACTICE FOR WATER INFRASTRUCTURE
 2. TRENCH DETAILS TO BE CONSTRUCTED IN ACCORDANCE WITH THE UE WASTEWATER INFRASTRUCTURE STANDARD DETAILS STD-WW-13
 3. ALL SLUICE VALVES AND ASSOCIATED CHAMBERS ARE TO BE CONSTRUCTED IN ACCORDANCE WITH THE UE WATER INFRASTRUCTURE STANDARD DETAILS STD-W-15
 4. ALL FIRE HYDRANT'S AND ASSOCIATED CHAMBERS ARE TO BE CONSTRUCTED IN ACCORDANCE WITH THE UE WATER INFRASTRUCTURE STANDARD DETAILS STD-W-18 AND STD-W-19
 4. ALL AIR VALVE'S AND ASSOCIATED CHAMBERS ARE TO BE CONSTRUCTED IN ACCORDANCE WITH THE UE WATER INFRASTRUCTURE STANDARD DETAILS STD-W-22 AND STD-W-23
 5. ALL WATER METERS AND ASSOCIATED CHAMBERS ARE TO BE CONSTRUCTED IN ACCORDANCE WITH THE UE WATER INFRASTRUCTURE STANDARD DETAILS STD-W-26A
 4. ALL WATER CUSTOMER CONNECTION AND BOUNDARY BOXES ARE TO BE CONSTRUCTED IN ACCORDANCE WITH THE UE WATER INFRASTRUCTURE STANDARD DETAILS STD-WW-13
 5. TYPICAL SERVICE LAYOUT SEPARATION DISTANCES TO BE IN ACCORDANCE WITH THE UE WATER INFRASTRUCTURE STANDARD DETAILS STD-W-11
 6. ALL WATER MARKER POSTS / PLATES TO BE CONSTRUCTED IN ACCORDANCE WITH THE UE WATER INFRASTRUCTURE STANDARD DETAILS STD-W-27
 7. ALL WATER MAIN THRUST AND SUPPORT BLOCKS TO BE CONSTRUCTED IN ACCORDANCE WITH THE UE WATER INFRASTRUCTURE STANDARD DETAILS STD-W-28
 8. ALL WASHOUT HYDRANTS TO BE CONSTRUCTED IN ACCORDANCE WITH THE UE WATER INFRASTRUCTURE STANDARD DETAILS STD-W-30A
 9. AIR VALVE AND FIRE HYDRANT COVERS, WHERE LOCATED IN GRASS AREAS, SHALL BE SURROUNDED BY A CONCRETE PLINTH, 200mm ALL ROUND AND 100mm DEEP FORMED WITH C75 CONCRETE, 20mm AGGREGATE SIZE, BEDDED IN CLAUSE 804 MATERIAL. THE PLINTH SHALL INCORPORATE MILD STEEL REINFORCEMENT LINKS AND SHALL HAVE A BULL-NOSE FINISH AROUND ITS EXTERNAL PERIMETER.
 10. METERS FOR APARTMENTS OR SIMILAR PROPERTIES WILL BE INSTALLED INTERNALLY WITHIN THE PREMISES IN ACCORDANCE WITH THE BUILDING CONTROLS AUTHORITY REQUIREMENTS AND SUBJECT TO REVIEW BY IRISH WATER.

- LEGEND:**
- PROPOSED SITE RED-LINE BOUNDARY
 - PROPOSED DWELLING / BUILDING FOOTPRINT
 - FFL 24.600 PROPOSED FINISHED FLOOR LEVEL
 - PROPOSED WATERMAIN, 150mm Ø HDPE PE100 SDR17
 - PROPOSED WATERMAIN, 100mm Ø HDPE PE100 SDR17
 - EXISTING WATERMAIN
 - Sv PROPOSED SLUICE VALVE, STD-W-15
 - Scv PROPOSED SCOUR VALVE, STD-W-30B
 - H PROPOSED FIRE HYDRANT, STD-W-19
 - W PROPOSED WASHOUT HYDRANT, STD-W-30A
 - AV PROPOSED AIR VALVE, STD-W-22
 - BB PROPOSED BOUNDARY BOX AND HOUSE CONNECTION, STD-W-03
 - M PROPOSED COMMERCIAL METER
 - TB PROPOSED THRUST BLOCK IN ACCORDANCE WITH UE STD-W-28
 - 6m FIRE HYDRANT SEPARATION DISTANCE IDENTIFIER
 - 46m FIRE HYDRANT COVERAGE IDENTIFIER

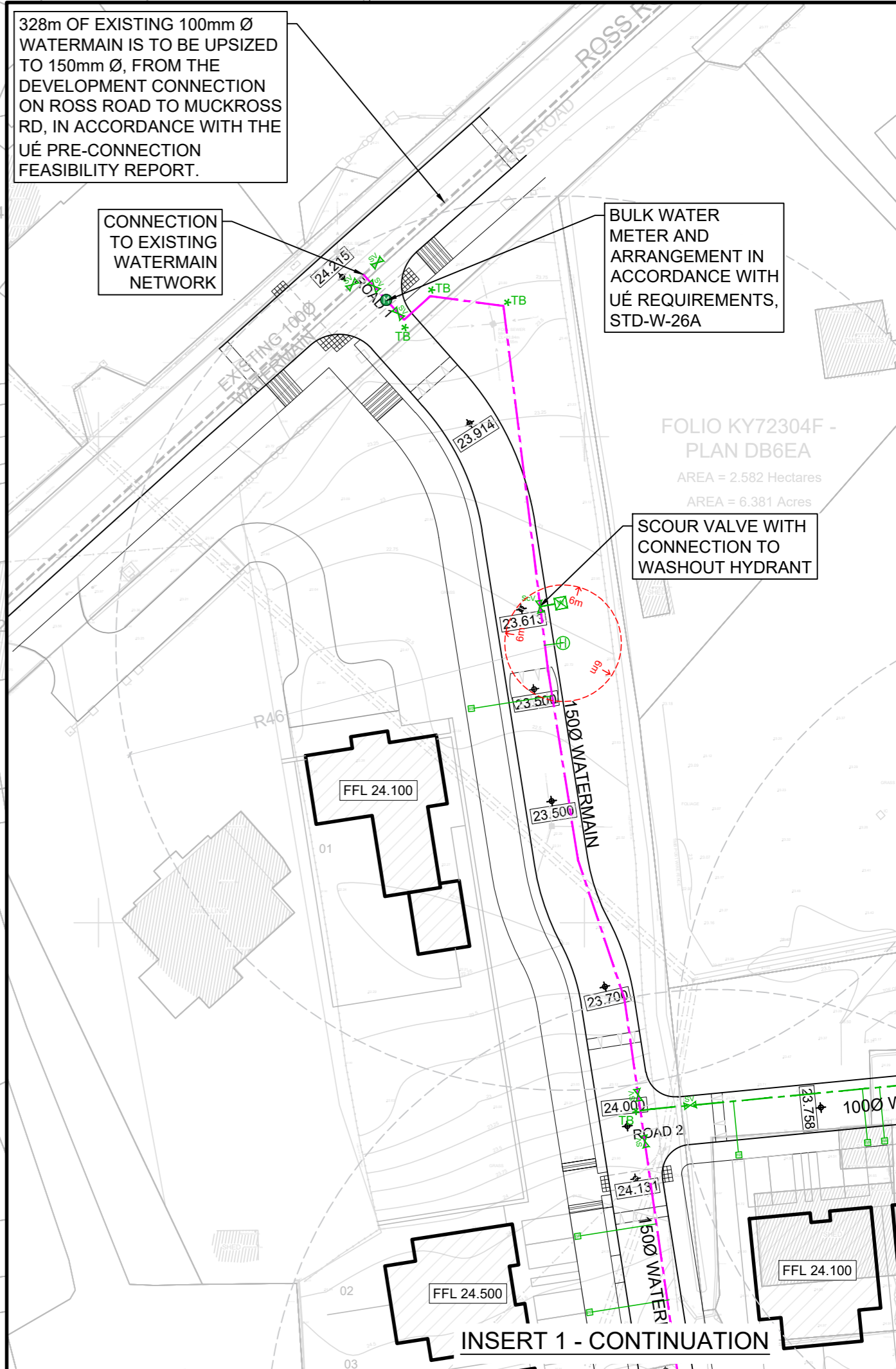

- GENERAL NOTES:**
1. ALL DIMENSIONS ARE IN METERS UNLESS NOTED OTHERWISE.
 2. ALL LEVELS ARE TO MALIN HEAD DATUM.
 3. ONLY WRITTEN DIMENSIONS SHALL BE USED. NO DIMENSIONS SHALL BE SCALED FROM THE DRAWINGS. CONTRACTOR TO CHECK ALL DIMENSIONS ON SITE.
 4. ALL COORDINATES ARE TO IRISH TRANSVERSE MERCATOR
 5. ALL DRAWINGS ARE TO BE READ IN CONJUNCTION WITH THE PROJECT SPECIFICATIONS.
 7. COPYRIGHT OSL.

REV	DATE	DESCRIPTION	BY	CHKD	AUTH
P04	01.08.25	ISSUED FOR PLANNING	BJM	DB	DB
P03	09.04.25	ISSUED FOR UE DESIGN VETTING	DV	BJM	DB
P02	09.04.25	ISSUED FOR SECTION 32B SUBMISSION	DV	BJM	DB
P01	28.03.25	ISSUED FOR INFORMATION	DV	BJM	DB

OSL-BUTLER
CONSULTING ENGINEERS

Civil, Structural & Project Engineering Services
Unit 38 Eastgate Drive, Little Island, Cork T45 Y049
Tel: +353 21 4297672

CLIENT	HOMELAND PROJECTS LTD.
PROJECT	LARGE-SCALE RESIDENTIAL DEVELOPMENT AT ROSS ROAD, KILLARNEY, CO. KERRY
PURPOSE	FOR PLANNING

TITLE	PROPOSED WATERMAIN LAYOUT PLAN		
ORIGINAL SCALE	A1 - 1:500	ORIGINAL ISSUE DATE	27.02.25
STATUS	S2	DRAWING NO	24041-OSL-11-DR-C-1140
REV			P04